

Tubular cable lugs 10 – 50 mm² for flexible conductors

material: Cu according to DIN EN 13600

surface: tin plated – type: without or optionally with inspection hole

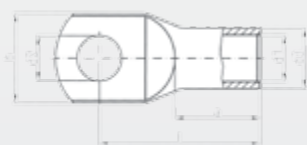

cross section mm ² min. cable-Ø	flat hole M	art.-no. without inspection hole	dimensions in mm						weight 100 pcs./kg	packing units (pcs.)	art.-no. with inspection hole	tool recommendation
			d1	d3	d2	b	l	a				
10 f	5	13510	5	8	5,3	12	23	12	0,70	100	13610	FW 10/70 140 MP 1 144 MP 2 147, API 35 + HPI 35 162, HPW 15 163 AP 10 152, HPI 10 + HPW 10 153, API 20 156, HPI 20 + HPW 20 157, API 30 + HPI 30 161, HPW 17 163, Stilo 1 150
.....	6	13511			6,4	12	25		0,76	100	13611	
4,0 mm	8	13512			8,4	15	28		0,89	100	13612	
	10	13513			10,5	18	31		0,98	100	13613	
	12	13514			13	20	32		1,00	100	13614	
16 f	5	13585	6	9	5,3	14	25,5	13	0,94	100	13685	
.....	6	13515			6,4	14	27		1,01	100	13615	
5,0 mm	8	13516			8,4	15	29,5		1,12	100	13616	
	10	13517			10,5	18	32		1,12	100	13617	
	12	13518			13	20	33		1,18	100	13618	
25 f	6	13520	7,7	10,7	6,4	16	32	16	1,47	100	13620	
.....	8	13521			8,4	16	34		1,43	100	13621	
6,5 mm	10	13522			10,5	18	35		1,53	100	13622	
	12	13523			13	20	36		1,61	100	13623	
	16	13524			17	26	40,5		1,91	100	13624	
35 f	6	13583	9,2	12,4	6,4	18	36	18	2,07	100	13683	
.....	8	13525			8,4	18	36		2,07	100	13625	
7,8 mm	10	13526			10,5	18	38		2,14	100	13626	
	12	13527			13	23	40		2,22	100	13627	
	16	13528			17	26	45		2,44	100	13628	
50 f	6	13584	11,2	14,8	6,4	22	42	21	3,25	100	13684	
.....	8	13530			8,4	22	42		3,22	100	13630	
9,0 mm	10	13531			10,5	22	43		3,33	100	13631	
	12	13532			13	23	44		3,39	100	13632	
	14	13581			15	25	45,5		3,60	100	13681	
	16	13533			17	28	48,5		3,65	100	13633	

Tubular cable lugs 70 – 240 mm² for flexible conductors

material: Cu according to DIN EN 13600

surface: tin plated – type: without or optionally with inspection hole

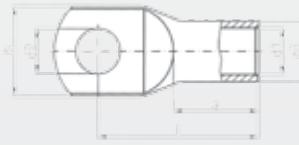

cross section mm ² min. cable-Ø	flat hole M	art.-no. without inspection hole	dimensions in mm						weight 100 pcs./kg	packing units (pcs.)	art.-no. with inspection hole	tool recommendation
			d1	d3	d2	b	l	a				
70 f	6	13534	13,5	17,5	6,4	25	46	23	4,43	50	13634	FW 10/70 140 AP 10 152, HPI 10 + HPW 10 153, MP 2 147 API 20 156, HPI 20 + HPW 20 157, API 30 + HPI 30 161 HPW 17 163, HPW 15 163, API 35 + HPI 35 162
	8	13535			8,4	25	45,5		4,80	50	13635	
11,0 mm	10	13536			10,5	25	47		4,84	50	13636	
	12	13537			13	26	47		4,84	50	13637	
	16	13538			17	28	50		5,05	50	13638	
	20	13539			21	31	54,5		5,52	50	13639	
95 f	6	13588	15,5	20	6,4	29	50,5	26	6,50	50	13688	
	8	13586			8,4	29	50,5		6,62	50	13686	
13,0 mm	10	13540			10,5	29	53		7,15	50	13640	
	12	13541			13	29	52,5		7,11	50	13641	
	16	13542			17	29	55		7,19	50	13642	
	20	13543			21	35	60		7,61	50	13643	
120 f	10	13545	16,8	21,3	10,5	31	56,5	29	8,07	50	13645	
	12	13546			13	31	56		8,07	50	13646	
15,0 mm	16	13547			17	31	58		8,36	50	13647	
	20	13548			21	35	63		8,75	50	13648	
150 f	10	13549	19	24	10,5	35	59	30	10,40	25	13649	
	12	13550			13	35	58,5		10,62	25	13650	
16,3 mm	16	13551			17	35	63		11,19	25	13651	
	20	13552			21	35	66		11,61	25	13652	
185 f	10	13589	21	26	10,5	38	67	35	13,03	25	13689	
	12	13590			13	38	67		12,15	25	13690	
18,5 mm	16	13592			17	38	69,5		12,88	25	13692	
	20	13593			21	38	71		13,95	25	13693	
240 f	12	13595	24	30	13	44	82	42	21,40	20	13695	
	16	13597			17	44	85		21,94	20	13697	
20,5 mm	20	13598			21	44	85		22,20	20	13698	